

**LARGE, TWO BED, TWO BATHROOM APARTMENT**



- ◆ Fourth floor apartment
- ◆ Large internal layout
- ◆ Two bedrooms, two bathrooms
- ◆ Separate laundry room
- ◆ Close to communal balcony
- ◆ All carpets and flooring included
- ◆ All white goods included\*
- ◆ Sold unfurnished, previously owned

**MASTER BEDROOM WITH ENSUITE**



**COMMUNAL BALCONY**



# 14 BROOKMEAD

## APARTMENT TYPE L

PLOTS 1, 3, 5, 11, 14 and 16  
BEDROOMS 2  
SHOWER ROOMS 2

**Kitchen/dining/living area**  
9.2m x 4.1m / 30'2" x 13'5"

**Bedroom 1**  
5.7m x 3.6m / 18'8" x 11'10"

**Shower room 1**  
3.4m x 2.2m / 11'2" x 7'3"

**Bedroom 2**  
3.4m x 3.7m / 11'2" x 12'2"

**Shower room 2**  
2.5m x 1.7m / 8'2" x 5'7"

**Laundry room**  
2.1m x 1.5m / 6'11" x 4'11"

**Total area**  
101m<sup>2</sup> / 120yd<sup>2</sup>

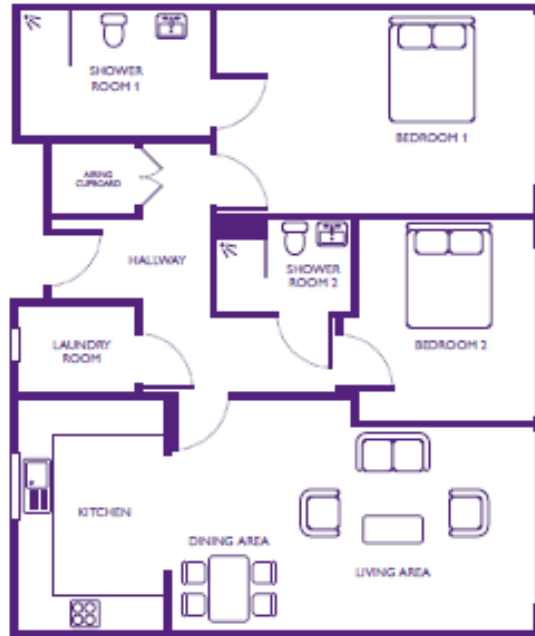

Dimensions shown are maximum. Some plots are handed compared to floorplans. Certain particulars may vary, please check with our sales team. The floor plans depict a typical layout of this apartment type. Floor plans are not to scale. September 2016.

Building converted in August 2017. Please note that this apartment is sold unfurnished and furniture in this floorplan is for reference only. Dimensions shown are maximum. Some plots are handed compared to floorplans. Certain particulars may vary, please check with our sales team. The floorplans depict a typical layout of this apartment type. Floorplans are not to scale. A surrender fee is payable when the property is returned to the Trust (ranging from 1% to 10% of purchase price depending on the lease and length of occupation).

\*Neff cooker, Bosch fridge/freezer, dishwasher, washing machine and tumble dryer included.

## SALES ENQUIRIES

If you are interested in viewing any of our apartments or would like some further information please call our Sales Team on

**0117 949 4004**

email [sales.team@stmonicastrust.org.uk](mailto:sales.team@stmonicastrust.org.uk)

[thechocolatequarter.org.uk](http://thechocolatequarter.org.uk)



St Monica Trust

