

## TWO BED APARTMENT WITH STUNNING VIEWS



- ◆ Third floor apartment
- ◆ High ceilings
- ◆ Two bedrooms, one en-suite
- ◆ Separate laundry room
- ◆ Sold unfurnished
- ◆ All carpets and flooring included
- ◆ Close to lifts and stairs
- ◆ All white goods included

Furniture shown for illustrative purposes only



# 63 RIVER HOUSE

## APARTMENT TYPE B

**PLOTS** 2-4, 6-14, 16-18, 21-23, 25-32, 34-36, 39-41, 43-50, 52-54, 57-59, 61-68 and 70-72

**BEDROOMS** 2

**SHOWER ROOMS** 1 plus WC

**Kitchen/dining/living area**  
8.7m x 3.6m / 28'7" x 11'10"

**Bedroom 1**  
4.8m x 3.6m / 15'9" x 11'10"

**Shower room**  
2.5m x 2.0m / 8'2" x 6'7"

**Bedroom 2**  
3.6m x 3.6m / 11'10" x 11'10"

**WC**  
1.4m x 1.8m / 4'7" x 5'11"

**Laundry room**  
1.9m x 1.8m / 6'3" x 5'11"

**Total area**  
87m<sup>2</sup> / 104yd<sup>2</sup>

### Private terrace

This apartment may be available with a terrace, please refer to building plans and speak to the sales team for availability.

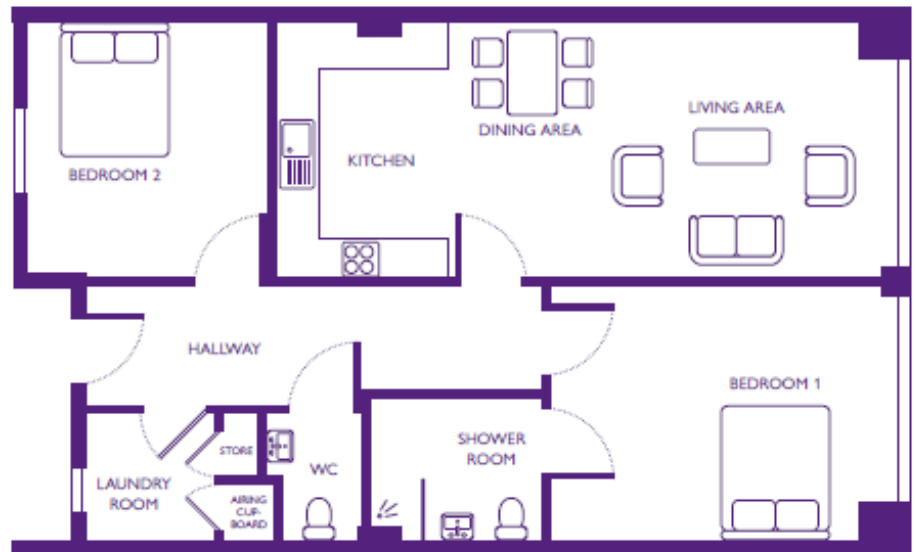

**Please note that this apartment is sold unfurnished** and furniture in this floorplan is for reference only. Dimensions shown are maximum. Some plots are handed compared to floorplans. Certain particulars may vary, please check with our sales team. The floorplans depict a typical layout of this apartment type. Floorplans are not to scale. A surrender fee is payable when the property is returned to the Trust.

## SALES ENQUIRIES

If you are interested in viewing any of our apartments or would like some further information please call our Sales Team on

**0117 949 4004**

email [sales.team@stmonicatrust.org.uk](mailto:sales.team@stmonicatrust.org.uk)

[thechocolatequarter.org.uk](http://thechocolatequarter.org.uk)



St Monica Trust

