

# NIBSFIELD

Show home opening times are shown on the website  
 The Chocolate Quarter, Somerdale, Somerdale Road,  
 Keynsham, Bristol BS31 2AU

If you have any questions, would like to arrange a viewing or  
 you would like more information please call **0117 949 4004**  
 or email [sales.team@stmonicatrust.org.uk](mailto:sales.team@stmonicatrust.org.uk)

[www.TheChocolateQuarter.org.uk](http://www.TheChocolateQuarter.org.uk)

## APARTMENT TYPE M

**PLOTS** 4 and 12

**BEDROOMS** 2

**SHOWER ROOMS** 2

**Kitchen/dining/living area**

7.5m x 4.5m / 24'7" x 14'9"

**Bedroom 1**

5.7m x 3.6m / 18'8" x 11'10"

**Shower room 1**

3.4m x 2.2m / 11'2" x 7'3"

**Bedroom 2**

3.4m x 3.7m / 11'2" x 12'2"

**Shower room 2**

2.5m x 1.7m / 8'2" x 5'7"

**Laundry room**

2.0m x 1.6m / 6'7" x 5'3"

**Total area**

95m<sup>2</sup> / 114yd<sup>2</sup>

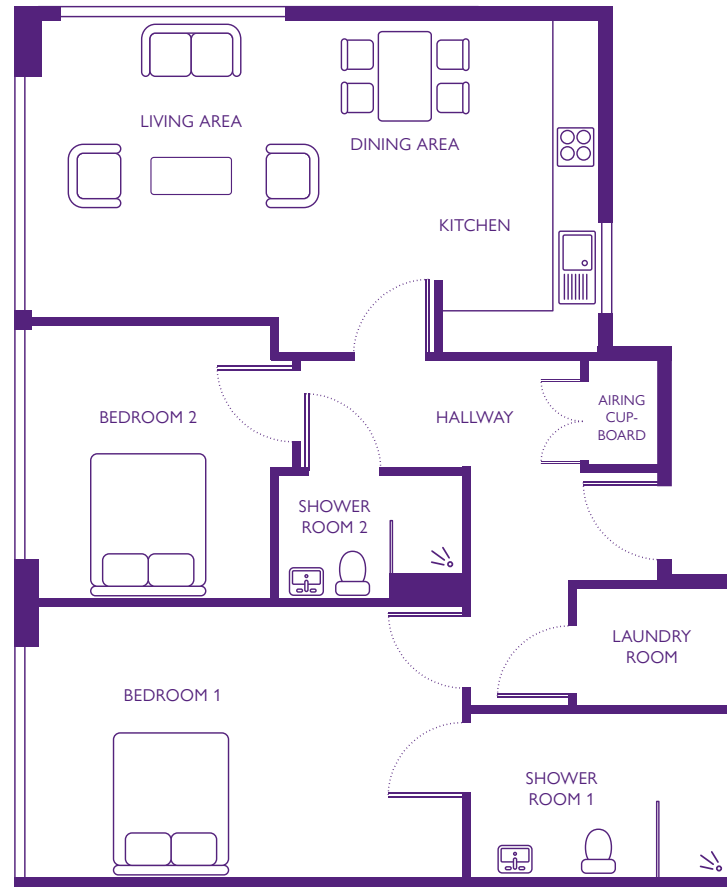

Dimensions shown are maximum. Some plots are handed compared to floorplans. Certain particulars may vary, please check with our sales team.  
 The floor plans depict a typical layout of this apartment type. Floor plans are not to scale. September 2016.