

MARKSBURY

Show home opening times are shown on the website
 The Chocolate Quarter, Somerdale, Somerdale Road,
 Keynsham, Bristol BS31 2AU

If you have any questions, would like to arrange a viewing or
 you would like more information please call **0117 949 4004**
 or email sales.team@stmonicastrust.org.uk

www.TheChocolateQuarter.org.uk

APARTMENT TYPE F

PLOTS 75-77, 79-86 and 88-90

BEDROOMS 2

SHOWER ROOMS 1 plus WC

Kitchen/dining/living area

7.7m x 3.6m / 25'3" x 11'10"

Bedroom 1

3.6m x 3.6m / 11'10" x 11'10"

Shower room

2.5m x 2.0m / 8'2" x 6'7"

Bedroom 2

3.4m x 3.6m / 11'2" x 11'10"

WC

1.4m x 1.9m / 4'7" x 6'3"

Laundry room

1.8m x 1.9m / 5'11" x 6'3"

Private terrace

1.1m x 7.5m / 3'7" x 24'7"

Total area

78m² / 93yd²

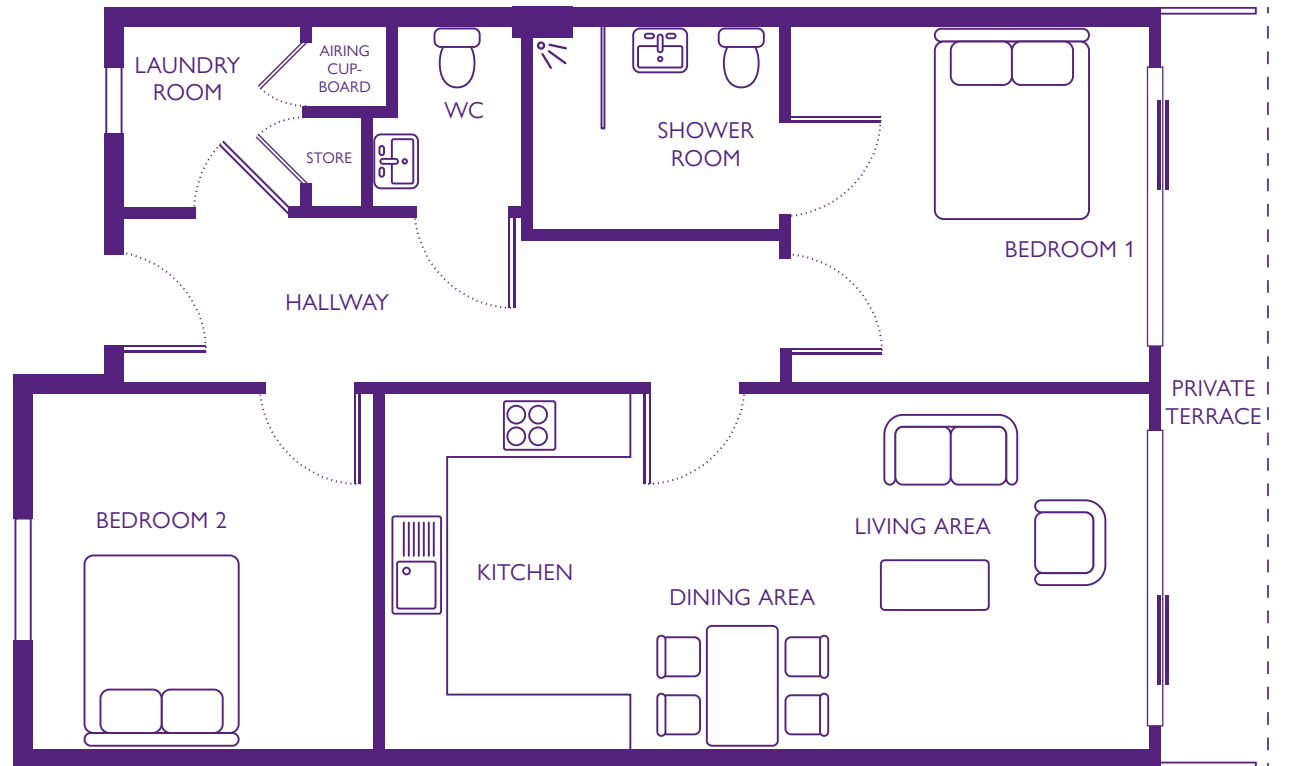

Dimensions shown are maximum. Some plots are handed compared to floorplans. Certain particulars may vary, please check with our sales team.
 The floor plans depict a typical layout of this apartment type. Floor plans are not to scale. September 2016.